

0090PAB1
00
EXT
2,204.71

0090PAB1
00
INT
2,021.24

NOTES
DO NOT SCALE FROM THIS DRAWING.
It is the Contractor's responsibility to check all governing dimensions and verify all dimensions on site before commencing any work or making any shop drawings.
This drawing is to be read in conjunction with schedules of work, specifications, bills of quantities and other relevant information. Work and materials are to be in accordance with the Building Regulations and to comply with the relevant British Standards.
This drawing is copyright of Calderdale Council and should not be reproduced in whole or part without their written permission.

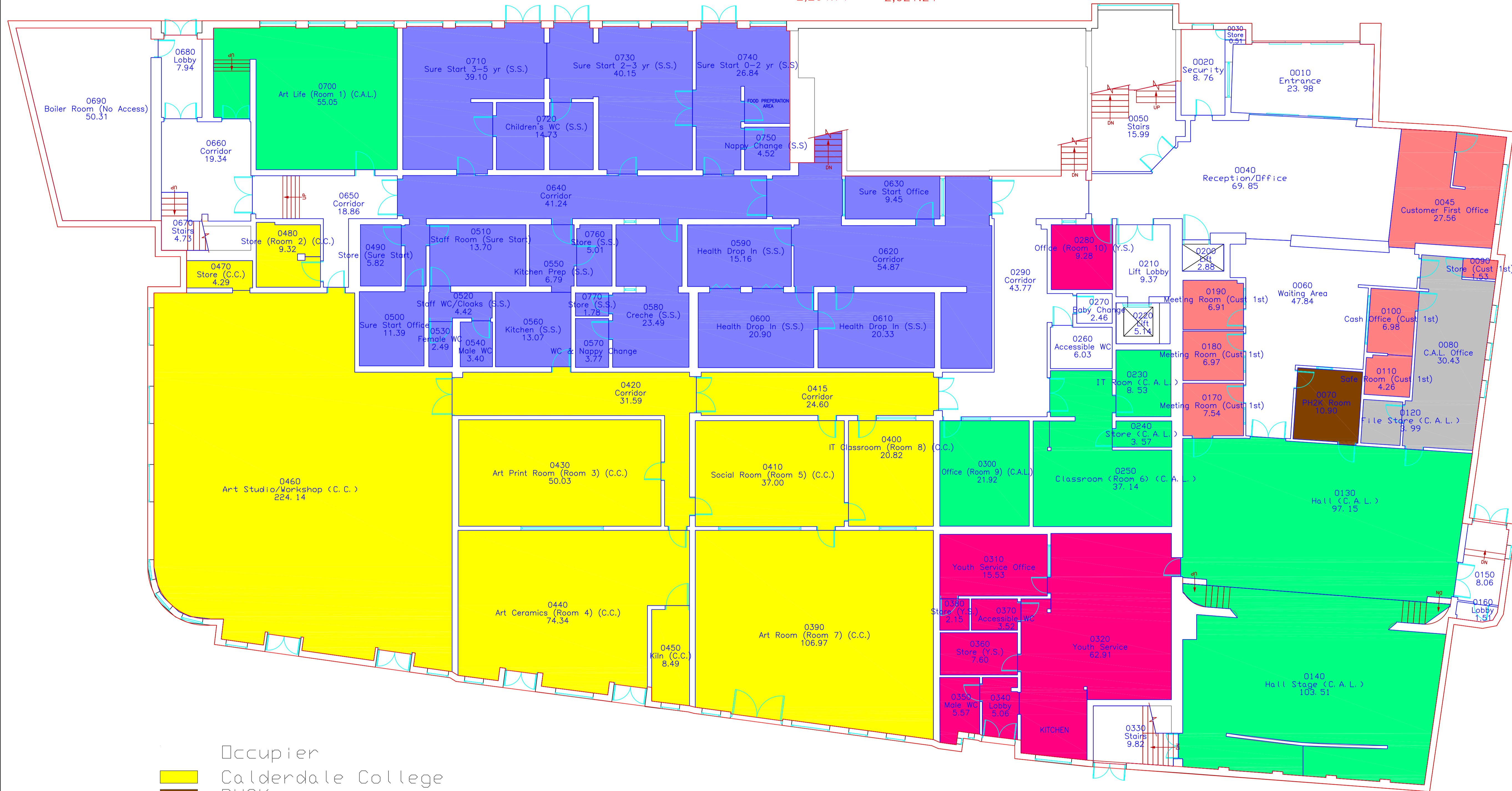

- Occupier
- Calderdale College
 - PH2K
 - Sure Start
 - Youth Service
 - Calderdale Adult Learning (Op)
 - Calderdale Adult Learning
 - Customer First

Rev	Date	Revision

PRELIMINARY

Project
**CALDERDALE MBC
CONDITION &
MEASURED SURVEY**

Drawing Title
**GROUND FLOOR
TODMORDEN
COMMUNITY COLLEGE
TODMORDEN**

WESTGATE HOUSE, WESTGATE,
HALIFAX, HX1 1PS
Tel: 0845 245 6000 Fax: 01422 392059

Date	Scale	Drawn by
DEC 09	1:100 @ A1	JK/JN

Drawing No.	Revision
0090PAB1-00-FM	