

NOTES
 DO NOT SCALE FROM THIS DRAWING.
 It is the Contractor's responsibility to check all governing dimensions and verify all dimensions on site before commencing any work or making any shop drawings.
 This drawing is to be read in conjunction with schedules of work, specifications, bills of quantities and other relevant information. Work and materials are to be in accordance with the Building Regulations and to comply with the relevant British Standards.
 This drawing is copyright of Calderdale Council and should not be reproduced in whole or part without their written permission.

0090PAB1 0090PAB1
 01 01
 EXT INT
 729.39 673.51

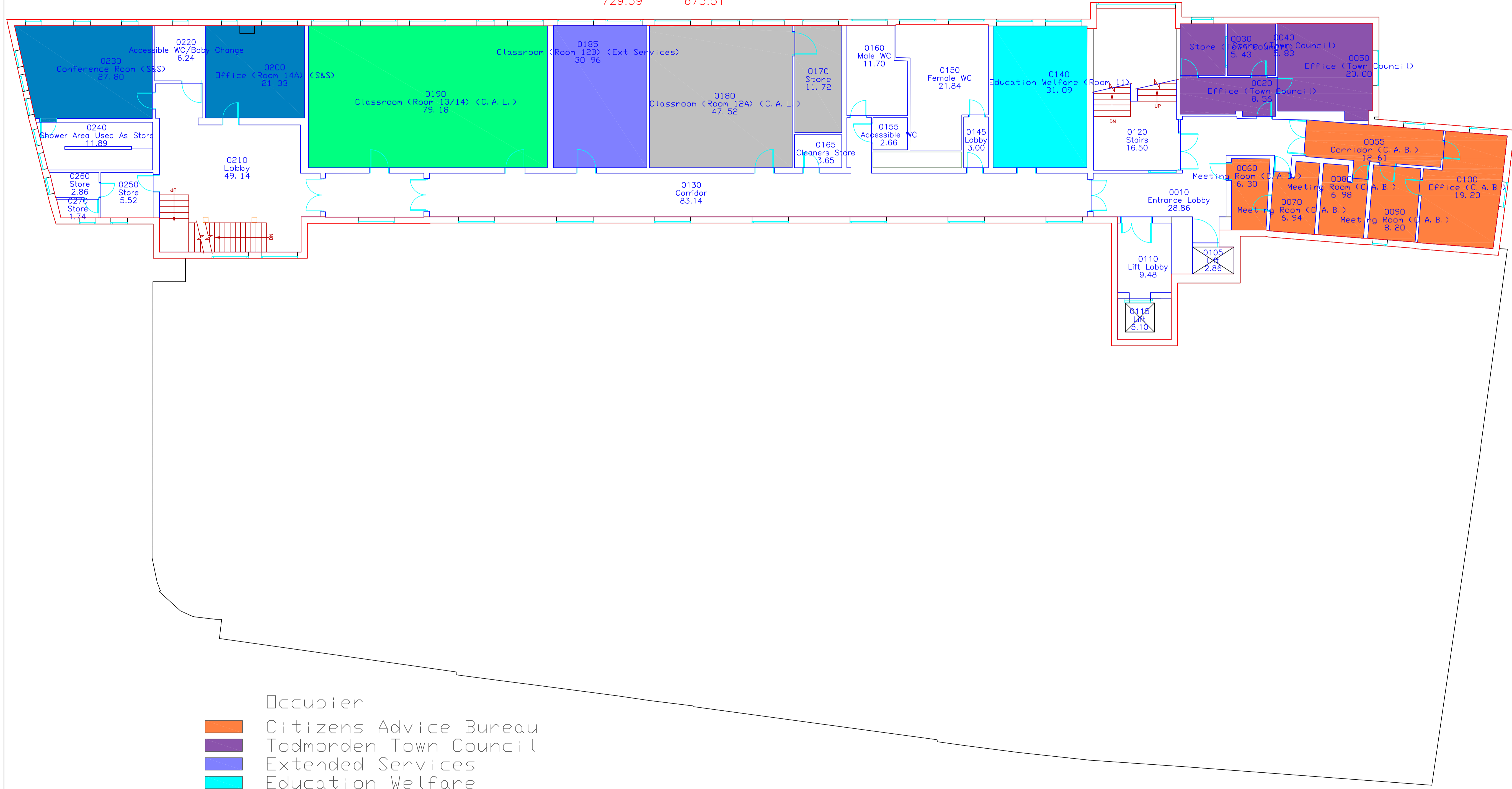

- Occupier
- Citizens Advice Bureau
 - Todmorden Town Council
 - Extended Services
 - Education Welfare
 - Calderdale Adult Learning (Op)
 - Calderdale Adult Learning
 - Neighbourhood's & Community Engagement

Rev	Date	Revision

PRELIMINARY

Project
**CALDERDALE MBC
 CONDITION &
 MEASURED SURVEY**

Drawing Title
**FIRST FLOOR
 TODMORDEN
 COMMUNITY COLLEGE
 TODMORDEN**

**WESTGATE HOUSE, WESTGATE,
 HALIFAX, HX1 1PS
 Tel: 0845 245 6000 Fax: 01422 392059**

Date	Scale	Drawn by
OCT 08	1:100 @ A1	JK

Drawing No.	Revision
0090PAB1-01-FM	